



Gala heat shrink boot is designed to securely connect and protect cables, connectors, and distribution points, preventing corrosion and mechanical damage. It features multiple openings that allow for multi-branch cable configurations, accommodating different cable angles and branching needs. By providing stress relief, it helps maintain the integrity of cable connectors, reducing wear and tear over time.

Additionally, the boot offers excellent electrical insulation, ensuring safe and reliable performance in various environments. Its strong sealing properties provide mechanical protection, preventing dust, moisture, and other contaminants from affecting the cables and their components.

With its durability and adaptability, the Gala heat shrink boot meets the high standards required for public transportation, military, and commercial applications, making it a dependable choice for securing cable connections in demanding conditions.

➤ FEATURES AND BENEFITS

- Excellent Electrical Strength & Mechanical toughness
- Excellent resistance to weathering, Chemicals, Oil, Fuel & Solvents
- Easy to install
- Wide operating temperature range
- Available in multiple material options
- The inner wall is pre-coated to ensure sealing and waterproof protection

Heat Shrink Boot Product Numbering Rules

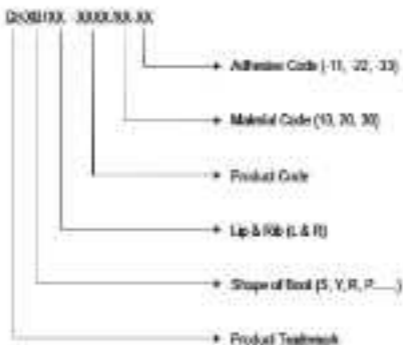

Heat Shrink Boot Material Characteristic

Adhesive Code	Material Characteristics	Operating Temperature	Installation Temperature
11	Soft hard/Flat Surface Modified Chloride	-20°C to 100°C	110°C
22	Low weight Flame Retardant Polyamide	-20°C to 120°C	130°C
33	Low Smoke Zero Halogen Polyamide	-20°C to 100°C	140°C

Heat Shrink Boot Adhesive Characteristic

Adhesive Code	Adhesive Characteristics	Operating Temperature
11	General Purpose Hot Melt Adhesive	60°C to 120°C
22	High Performance Hot Melt Adhesive	-20°C to 80°C
33	Specialty Adhesive	-20°C to 150°C

► Heat Shrink Straight Boot (3 Lip & Rib)

Galv Heat Shrink boots feature two or three lip positions, working with connectors to provide mechanical protection and strain relief. They also replace outer cable armor when connected.

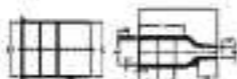

Selection Chart :

Product	W (mm)	H (mm)	W (mm)	H (mm)	W (mm)	H (mm)	W (mm)	H (mm)	W (mm)	H (mm)	W (mm)	H (mm)
HTSH3-200	200	200	200	200	200	200	200	200	200	200	200	200
HTSH3-250	250	250	250	250	250	250	250	250	250	250	250	250
HTSH3-300	300	300	300	300	300	300	300	300	300	300	300	300
HTSH3-350	350	350	350	350	350	350	350	350	350	350	350	350
HTSH3-400	400	400	400	400	400	400	400	400	400	400	400	400
HTSH3-450	450	450	450	450	450	450	450	450	450	450	450	450
HTSH3-500	500	500	500	500	500	500	500	500	500	500	500	500
HTSH3-550	550	550	550	550	550	550	550	550	550	550	550	550
HTSH3-600	600	600	600	600	600	600	600	600	600	600	600	600
HTSH3-650	650	650	650	650	650	650	650	650	650	650	650	650
HTSH3-700	700	700	700	700	700	700	700	700	700	700	700	700
HTSH3-750	750	750	750	750	750	750	750	750	750	750	750	750
HTSH3-800	800	800	800	800	800	800	800	800	800	800	800	800
HTSH3-850	850	850	850	850	850	850	850	850	850	850	850	850
HTSH3-900	900	900	900	900	900	900	900	900	900	900	900	900
HTSH3-950	950	950	950	950	950	950	950	950	950	950	950	950
HTSH3-1000	1000	1000	1000	1000	1000	1000	1000	1000	1000	1000	1000	1000

Galv Electronics Pvt. Ltd.

► Heat Shrink P Type Boot

Galv Heat Shrink boot is designed for coaxial connectors, providing mechanical protection and strain relief. Made from high quality cross-linked polyolefin, it replaces outer cable armor when connected, ensuring secure mating and long term reliability in military, aerospace, and industrial applications.

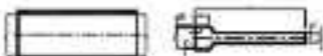

Selection Chart :

Product	W (mm)	H (mm)	W (mm)	H (mm)	W (mm)	H (mm)	W (mm)	H (mm)	W (mm)	H (mm)	W (mm)	H (mm)
HTSH-P-200	200	200	200	200	200	200	200	200	200	200	200	200
HTSH-P-250	250	250	250	250	250	250	250	250	250	250	250	250
HTSH-P-300	300	300	300	300	300	300	300	300	300	300	300	300
HTSH-P-350	350	350	350	350	350	350	350	350	350	350	350	350
HTSH-P-400	400	400	400	400	400	400	400	400	400	400	400	400
HTSH-P-450	450	450	450	450	450	450	450	450	450	450	450	450
HTSH-P-500	500	500	500	500	500	500	500	500	500	500	500	500
HTSH-P-550	550	550	550	550	550	550	550	550	550	550	550	550
HTSH-P-600	600	600	600	600	600	600	600	600	600	600	600	600
HTSH-P-650	650	650	650	650	650	650	650	650	650	650	650	650
HTSH-P-700	700	700	700	700	700	700	700	700	700	700	700	700
HTSH-P-750	750	750	750	750	750	750	750	750	750	750	750	750
HTSH-P-800	800	800	800	800	800	800	800	800	800	800	800	800
HTSH-P-850	850	850	850	850	850	850	850	850	850	850	850	850
HTSH-P-900	900	900	900	900	900	900	900	900	900	900	900	900
HTSH-P-950	950	950	950	950	950	950	950	950	950	950	950	950
HTSH-P-1000	1000	1000	1000	1000	1000	1000	1000	1000	1000	1000	1000	1000

Galv Electronics Pvt. Ltd.

► Heat Shrink P Type Boot

GALA Heat Shrink Boot is specifically designed for use with connectors, offering excellent mechanical protection and stress relief for connectors. Crafted from high-quality cross-linked polyethylene, it enhances durability, ensures on-site sealing, and provides long-term reliability across military, aerospace, and industrial environments.

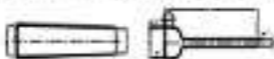

Selection Chart :

Connector	W (mm)	H (mm)	L (mm)	W (mm)	W (mm)	H (mm)	H (mm)	H (mm)	H (mm)	W (mm)	L (mm)
AMPTEC 200	20.0	12.0	11.0	1.0	1.0	10.0	10.0	10.0	10.0	1.0	10.0
AMPTEC 201	20.0	12.0	10.0	1.0	1.0	10.0	10.0	10.0	10.0	1.0	10.0
AMPTEC 202	20.0	12.0	10.0	1.0	1.0	10.0	10.0	10.0	10.0	1.0	10.0
AMPTEC 203	20.0	12.0	10.0	1.0	1.0	10.0	10.0	10.0	10.0	1.0	10.0
AMPTEC 204	20.0	12.0	10.0	1.0	1.0	10.0	10.0	10.0	10.0	1.0	10.0
AMPTEC 205	20.0	12.0	10.0	1.0	1.0	10.0	10.0	10.0	10.0	1.0	10.0
AMPTEC 206	20.0	12.0	10.0	1.0	1.0	10.0	10.0	10.0	10.0	1.0	10.0
AMPTEC 207	20.0	12.0	10.0	1.0	1.0	10.0	10.0	10.0	10.0	1.0	10.0
AMPTEC 208	20.0	12.0	10.0	1.0	1.0	10.0	10.0	10.0	10.0	1.0	10.0
AMPTEC 209	20.0	12.0	10.0	1.0	1.0	10.0	10.0	10.0	10.0	1.0	10.0
AMPTEC 210	20.0	12.0	10.0	1.0	1.0	10.0	10.0	10.0	10.0	1.0	10.0
AMPTEC 211	20.0	12.0	10.0	1.0	1.0	10.0	10.0	10.0	10.0	1.0	10.0
AMPTEC 212	20.0	12.0	10.0	1.0	1.0	10.0	10.0	10.0	10.0	1.0	10.0
AMPTEC 213	20.0	12.0	10.0	1.0	1.0	10.0	10.0	10.0	10.0	1.0	10.0
AMPTEC 214	20.0	12.0	10.0	1.0	1.0	10.0	10.0	10.0	10.0	1.0	10.0
AMPTEC 215	20.0	12.0	10.0	1.0	1.0	10.0	10.0	10.0	10.0	1.0	10.0
AMPTEC 216	20.0	12.0	10.0	1.0	1.0	10.0	10.0	10.0	10.0	1.0	10.0
AMPTEC 217	20.0	12.0	10.0	1.0	1.0	10.0	10.0	10.0	10.0	1.0	10.0
AMPTEC 218	20.0	12.0	10.0	1.0	1.0	10.0	10.0	10.0	10.0	1.0	10.0
AMPTEC 219	20.0	12.0	10.0	1.0	1.0	10.0	10.0	10.0	10.0	1.0	10.0
AMPTEC 220	20.0	12.0	10.0	1.0	1.0	10.0	10.0	10.0	10.0	1.0	10.0

© GALA Electronics Pvt. Ltd.

► Heat Shrink P Type Boot

GALA Heat Shrink Boot is used with connectors to provide mechanical protection and stress relief for the connector. Made from high-quality cross-linked polyethylene, it offers on-site sealing, durability, and long-term reliability in military, aerospace, and industrial applications.

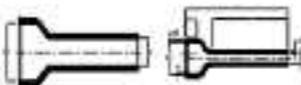

Selection Chart :

Connector	W (mm)	H (mm)	L (mm)	W (mm)	W (mm)	H (mm)	H (mm)	H (mm)	H (mm)	W (mm)	L (mm)
AMPTEC 220	20.0	12.0	10.0	1.0	1.0	10.0	10.0	10.0	10.0	1.0	10.0
AMPTEC 221	20.0	12.0	10.0	1.0	1.0	10.0	10.0	10.0	10.0	1.0	10.0
AMPTEC 222	20.0	12.0	10.0	1.0	1.0	10.0	10.0	10.0	10.0	1.0	10.0
AMPTEC 223	20.0	12.0	10.0	1.0	1.0	10.0	10.0	10.0	10.0	1.0	10.0
AMPTEC 224	20.0	12.0	10.0	1.0	1.0	10.0	10.0	10.0	10.0	1.0	10.0
AMPTEC 225	20.0	12.0	10.0	1.0	1.0	10.0	10.0	10.0	10.0	1.0	10.0
AMPTEC 226	20.0	12.0	10.0	1.0	1.0	10.0	10.0	10.0	10.0	1.0	10.0
AMPTEC 227	20.0	12.0	10.0	1.0	1.0	10.0	10.0	10.0	10.0	1.0	10.0
AMPTEC 228	20.0	12.0	10.0	1.0	1.0	10.0	10.0	10.0	10.0	1.0	10.0
AMPTEC 229	20.0	12.0	10.0	1.0	1.0	10.0	10.0	10.0	10.0	1.0	10.0
AMPTEC 230	20.0	12.0	10.0	1.0	1.0	10.0	10.0	10.0	10.0	1.0	10.0

© GALA Electronics Pvt. Ltd.

► Heat Shrink Right Angle Boot

Our Right Angle Heat Shrink Boot provides mechanical protection and stress relief. Designed without a lip, it shrinks directly onto the assembly, creating a secure fit and long-term stability in demanding applications.

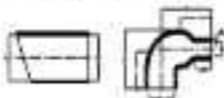

Selection Chart:

Part Number	ID (mm)	ID (inch)	OD (mm)	OD (inch)	Length (mm)	Length (inch)	Weight (g)	Weight (oz)	Weight (lb)	Weight (kg)
9999-0001	1.25	0.05	1.25	0.05	11.43	0.45	0.10	0.0035	0.0008	0.0004
9999-0002	1.25	0.05	1.25	0.05	22.86	0.90	0.20	0.0070	0.0018	0.0008
9999-0003	1.25	0.05	1.25	0.05	34.29	1.35	0.30	0.0105	0.0027	0.0012
9999-0004	1.25	0.05	1.25	0.05	45.72	1.80	0.40	0.0140	0.0036	0.0016
9999-0005	1.25	0.05	1.25	0.05	57.15	2.25	0.50	0.0175	0.0045	0.0020
9999-0006	1.25	0.05	1.25	0.05	68.58	2.70	0.60	0.0210	0.0054	0.0024
9999-0007	1.25	0.05	1.25	0.05	80.01	3.15	0.70	0.0245	0.0063	0.0028
9999-0008	1.25	0.05	1.25	0.05	91.44	3.60	0.80	0.0280	0.0072	0.0032
9999-0009	1.25	0.05	1.25	0.05	102.87	4.05	0.90	0.0315	0.0079	0.0036
9999-0010	1.25	0.05	1.25	0.05	114.30	4.50	1.00	0.0350	0.0088	0.0040
9999-0011	1.25	0.05	1.25	0.05	125.73	4.95	1.10	0.0385	0.0097	0.0044
9999-0012	1.25	0.05	1.25	0.05	137.16	5.40	1.20	0.0420	0.0106	0.0048
9999-0013	1.25	0.05	1.25	0.05	148.59	5.85	1.30	0.0455	0.0115	0.0052
9999-0014	1.25	0.05	1.25	0.05	160.02	6.30	1.40	0.0490	0.0124	0.0056
9999-0015	1.25	0.05	1.25	0.05	171.45	6.75	1.50	0.0525	0.0133	0.0060
9999-0016	1.25	0.05	1.25	0.05	182.88	7.20	1.60	0.0560	0.0142	0.0064
9999-0017	1.25	0.05	1.25	0.05	194.31	7.65	1.70	0.0595	0.0151	0.0068
9999-0018	1.25	0.05	1.25	0.05	205.74	8.10	1.80	0.0630	0.0160	0.0072
9999-0019	1.25	0.05	1.25	0.05	217.17	8.55	1.90	0.0665	0.0169	0.0076
9999-0020	1.25	0.05	1.25	0.05	228.60	9.00	2.00	0.0700	0.0178	0.0080
9999-0021	1.25	0.05	1.25	0.05	240.03	9.45	2.10	0.0735	0.0187	0.0084
9999-0022	1.25	0.05	1.25	0.05	251.46	9.90	2.20	0.0770	0.0196	0.0088
9999-0023	1.25	0.05	1.25	0.05	262.89	10.35	2.30	0.0805	0.0205	0.0092
9999-0024	1.25	0.05	1.25	0.05	274.32	10.80	2.40	0.0840	0.0214	0.0096
9999-0025	1.25	0.05	1.25	0.05	285.75	11.25	2.50	0.0875	0.0223	0.0100
9999-0026	1.25	0.05	1.25	0.05	297.18	11.70	2.60	0.0910	0.0232	0.0104
9999-0027	1.25	0.05	1.25	0.05	308.61	12.15	2.70	0.0945	0.0241	0.0108
9999-0028	1.25	0.05	1.25	0.05	320.04	12.60	2.80	0.0980	0.0250	0.0112
9999-0029	1.25	0.05	1.25	0.05	331.47	13.05	2.90	0.1015	0.0259	0.0116
9999-0030	1.25	0.05	1.25	0.05	342.90	13.50	3.00	0.1050	0.0268	0.0120
9999-0031	1.25	0.05	1.25	0.05	354.33	13.95	3.10	0.1085	0.0277	0.0124
9999-0032	1.25	0.05	1.25	0.05	365.76	14.40	3.20	0.1120	0.0286	0.0128
9999-0033	1.25	0.05	1.25	0.05	377.19	14.85	3.30	0.1155	0.0295	0.0132
9999-0034	1.25	0.05	1.25	0.05	388.62	15.30	3.40	0.1190	0.0304	0.0136
9999-0035	1.25	0.05	1.25	0.05	400.05	15.75	3.50	0.1225	0.0313	0.0140
9999-0036	1.25	0.05	1.25	0.05	411.48	16.20	3.60	0.1260	0.0322	0.0144
9999-0037	1.25	0.05	1.25	0.05	422.91	16.65	3.70	0.1295	0.0331	0.0148
9999-0038	1.25	0.05	1.25	0.05	434.34	17.10	3.80	0.1330	0.0340	0.0152
9999-0039	1.25	0.05	1.25	0.05	445.77	17.55	3.90	0.1365	0.0349	0.0156
9999-0040	1.25	0.05	1.25	0.05	457.20	18.00	4.00	0.1400	0.0358	0.0160
9999-0041	1.25	0.05	1.25	0.05	468.63	18.45	4.10	0.1435	0.0367	0.0164
9999-0042	1.25	0.05	1.25	0.05	480.06	18.90	4.20	0.1470	0.0376	0.0168
9999-0043	1.25	0.05	1.25	0.05	491.49	19.35	4.30	0.1505	0.0385	0.0172
9999-0044	1.25	0.05	1.25	0.05	502.92	19.80	4.40	0.1540	0.0394	0.0176
9999-0045	1.25	0.05	1.25	0.05	514.35	20.25	4.50	0.1575	0.0403	0.0180
9999-0046	1.25	0.05	1.25	0.05	525.78	20.70	4.60	0.1610	0.0412	0.0184
9999-0047	1.25	0.05	1.25	0.05	537.21	21.15	4.70	0.1645	0.0421	0.0188
9999-0048	1.25	0.05	1.25	0.05	548.64	21.60	4.80	0.1680	0.0430	0.0192
9999-0049	1.25	0.05	1.25	0.05	560.07	22.05	4.90	0.1715	0.0439	0.0196
9999-0050	1.25	0.05	1.25	0.05	571.50	22.50	5.00	0.1750	0.0448	0.0200
9999-0051	1.25	0.05	1.25	0.05	582.93	22.95	5.10	0.1785	0.0457	0.0204
9999-0052	1.25	0.05	1.25	0.05	594.36	23.40	5.20	0.1820	0.0466	0.0208
9999-0053	1.25	0.05	1.25	0.05	605.79	23.85	5.30	0.1855	0.0475	0.0212
9999-0054	1.25	0.05	1.25	0.05	617.22	24.30	5.40	0.1890	0.0484	0.0216
9999-0055	1.25	0.05	1.25	0.05	628.65	24.75	5.50	0.1925	0.0493	0.0220
9999-0056	1.25	0.05	1.25	0.05	640.08	25.20	5.60	0.1960	0.0502	0.0224
9999-0057	1.25	0.05	1.25	0.05	651.51	25.65	5.70	0.1995	0.0511	0.0228
9999-0058	1.25	0.05	1.25	0.05	662.94	26.10	5.80	0.2030	0.0520	0.0232
9999-0059	1.25	0.05	1.25	0.05	674.37	26.55	5.90	0.2065	0.0529	0.0236
9999-0060	1.25	0.05	1.25	0.05	685.80	27.00	6.00	0.2100	0.0538	0.0240
9999-0061	1.25	0.05	1.25	0.05	697.23	27.45	6.10	0.2135	0.0547	0.0244
9999-0062	1.25	0.05	1.25	0.05	708.66	27.90	6.20	0.2170	0.0556	0.0248
9999-0063	1.25	0.05	1.25	0.05	720.09	28.35	6.30	0.2205	0.0565	0.0252
9999-0064	1.25	0.05	1.25	0.05	731.52	28.80	6.40	0.2240	0.0574	0.0256
9999-0065	1.25	0.05	1.25	0.05	742.95	29.25	6.50	0.2275	0.0583	0.0260
9999-0066	1.25	0.05	1.25	0.05	754.38	29.70	6.60	0.2310	0.0592	0.0264
9999-0067	1.25	0.05	1.25	0.05	765.81	30.15	6.70	0.2345	0.0601	0.0268
9999-0068	1.25	0.05	1.25	0.05	777.24	30.60	6.80	0.2380	0.0610	0.0272
9999-0069	1.25	0.05	1.25	0.05	788.67	31.05	6.90	0.2415	0.0619	0.0276
9999-0070	1.25	0.05	1.25	0.05	800.10	31.50	7.00	0.2450	0.0628	0.0280
9999-0071	1.25	0.05	1.25	0.05	811.53	31.95	7.10	0.2485	0.0637	0.0284
9999-0072	1.25	0.05	1.25	0.05	822.96	32.40	7.20	0.2520	0.0646	0.0288
9999-0073	1.25	0.05	1.25	0.05	834.39	32.85	7.30	0.2555	0.0655	0.0292
9999-0074	1.25	0.05	1.25	0.05	845.82	33.30	7.40	0.2590	0.0664	0.0296
9999-0075	1.25	0.05	1.25	0.05	857.25	33.75	7.50	0.2625	0.0673	0.0300
9999-0076	1.25	0.05	1.25	0.05	868.68	34.20	7.60	0.2660	0.0682	0.0304
9999-0077	1.25	0.05	1.25	0.05	880.11	34.65	7.70	0.2695	0.0691	0.0308
9999-0078	1.25	0.05	1.25	0.05	891.54	35.10	7.80	0.2730	0.0700	0.0312
9999-0079	1.25	0.05	1.25	0.05	902.97	35.55	7.90	0.2765	0.0709	0.0316
9999-0080	1.25	0.05	1.25	0.05	914.40	36.00	8.00	0.2800	0.0718	0.0320
9999-0081	1.25	0.05	1.25	0.05	925.83	36.45	8.10	0.2835	0.0727	0.0324
9999-0082	1.25	0.05	1.25	0.05	937.26	36.90	8.20	0.2870	0.0736	0.0328
9999-0083	1.25	0.05	1.25	0.05	948.69	37.35	8.30	0.2905	0.0745	0.0332
9999-0084	1.25	0.05	1.25	0.05	960.12	37.80	8.40	0.2940	0.0754	0.0336
9999-0085	1.25	0.05	1.25	0.05	971.55	38.25	8.50	0.2975	0.0763	0.0340
9999-0086	1.25	0.05	1.25	0.05	982.98	38.70	8.60	0.3010	0.0772	0.0344
9999-0087	1.25	0.05	1.25	0.05	994.41	39.15	8.70	0.3045	0.0781	0.0348
9999-0088	1.25	0.05	1.25	0.05	1005.84	39.60	8.80	0.3080	0.0790	0.0352
9999-0089	1.25	0.05	1.25	0.05	1017.27	40.05	8.90	0.3115	0.0799	0.0356
9999-0090	1.25	0.05	1.25	0.05	1028.70	40.50	9.00	0.3150	0.0808	0.0360
9999-0091	1.25	0.05	1.25	0.05	1040.13	40.95	9.10	0.3185	0.0817	0.0364
9999-0092	1.25	0.05	1.25	0.05	1051.56	41.40	9.20	0.3220	0.0826	0.0368
9999-0093	1.25	0.05	1.25	0.05	1062.99	41.85	9.30	0.3255	0.0835	0.0372
9999-0094	1.25	0.05	1.25	0.05	1074.42	42.30	9.40	0.3290	0.0844	0.0376
9999-0095	1.25	0.05	1.25	0.05	1085.85	42.75	9.50	0.3325	0.0853	0.0380
9999-0096	1.25	0.05	1.25	0.05	1097.28	43.20	9.60	0.3360	0.0862	0.0384
9999-0097	1.25	0.05	1.25	0.05	1108.71	43.65	9.70	0.3395	0.0871	0.0388
9999-0098	1.25	0.05	1.25	0.05	1120.14	44.10	9.80	0.3430	0.0880	0.0392
9999-0099	1.25	0.05	1.25	0.05	1131.57	44.55	9.90	0.3465	0.0889	0.0396
9999-0100	1.25	0.05	1.25	0.05	1143.00	45.00	10.00	0.3500	0.0898	0.0400

Minimums are in inches.

► Heat Shrink Right Angle Boot (Lip)

► Heat Shrink Right Angle Boot (Lip & Rib)

Data Heat Shrink Boot provides excellent protection while allowing easy removal for cables and plugs. Designed for stability, it prevents a common and long term reliability in demanding applications.

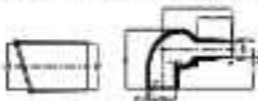

Selection Chart :

Part No.	Ø (mm)	Ø (mm)	Ø (mm)	Ø (mm)	Length (mm)	Length (mm)	Ø (mm)	Length (mm)	Length (mm)	Length (mm)	Length (mm)	Length (mm)
GHBC100-100	100	100	100	100	100	100	100	100	100	100	100	100
GHBC100-125	100	125	125	100	100	125	100	100	100	100	100	100
GHBC100-150	100	150	150	100	100	150	100	100	100	100	100	100
GHBC125-100	125	100	100	125	100	100	125	100	100	100	100	100
GHBC125-125	125	125	125	125	125	125	125	125	125	125	125	125
GHBC125-150	125	150	150	125	125	150	125	125	125	125	125	125
GHBC150-100	150	100	100	150	100	100	150	100	100	100	100	100
GHBC150-125	150	125	125	150	125	125	150	125	125	125	125	125
GHBC150-150	150	150	150	150	150	150	150	150	150	150	150	150

► All dimensions in mm.

► Heat Shrink L Type Boot

Data Heat Shrink Boot is used with circular connectors to provide mechanical protection and stress relief. When required, it also replaces outer cable jacket, ensuring durability and long term reliability in demanding applications.



Selection Chart :

Part No.	Ø (mm)	Ø (mm)	Ø (mm)	Ø (mm)	Length (mm)	Length (mm)	Ø (mm)	Length (mm)	Length (mm)	Length (mm)	Length (mm)
GHBL100-100	100	100	100	100	100	100	100	100	100	100	100
GHBL100-125	100	125	125	100	100	125	100	100	100	100	100
GHBL100-150	100	150	150	100	100	150	100	100	100	100	100
GHBL125-100	125	100	100	125	100	100	125	100	100	100	100
GHBL125-125	125	125	125	125	125	125	125	125	125	125	125
GHBL125-150	125	150	150	125	125	150	125	125	125	125	125
GHBL150-100	150	100	100	150	100	100	150	100	100	100	100
GHBL150-125	150	125	125	150	125	125	150	125	125	125	125
GHBL150-150	150	150	150	150	150	150	150	150	150	150	150

► All dimensions in mm.

Heat Shrink L Type Boot

Gala Heat Shrink Boot offers mechanical protection while allowing easy removal of cables and plugs. Designed for durability, it ensures a secure fit and long-term reliability in various applications.

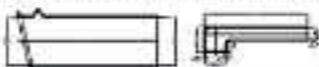

Selection Chart :

Part No.	W (mm)	H (mm)	L (mm)	P (mm)	W (mm)	H (mm)	L (mm)	P (mm)
0001-001	10.0	1.0	11.0	1.0	10.0	1.0	11.0	1.0
0001-002	11.0	1.0	12.0	1.0	11.0	1.0	12.0	1.0
0001-003	12.0	1.0	13.0	1.0	12.0	1.0	13.0	1.0
0001-004	13.0	1.0	14.0	1.0	13.0	1.0	14.0	1.0
0001-005	14.0	1.0	15.0	1.0	14.0	1.0	15.0	1.0
0001-006	15.0	1.0	16.0	1.0	15.0	1.0	16.0	1.0
0001-007	16.0	1.0	17.0	1.0	16.0	1.0	17.0	1.0

*Dimensions in mm

Heat Shrink T Type Boot

Gala T-Type Heat Shrink Boot provides protection and stress relief at cable bifurcations. Designed for durability, it ensures a secure fit and long-term reliability in demanding applications.



Selection Chart :

Part No.	W (mm)	H (mm)	L (mm)	P (mm)	W (mm)	H (mm)	L (mm)	P (mm)
0001-001	10.0	1.0	11.0	1.0	10.0	1.0	11.0	1.0
0001-002	11.0	1.0	12.0	1.0	11.0	1.0	12.0	1.0
0001-003	12.0	1.0	13.0	1.0	12.0	1.0	13.0	1.0
0001-004	13.0	1.0	14.0	1.0	13.0	1.0	14.0	1.0
0001-005	14.0	1.0	15.0	1.0	14.0	1.0	15.0	1.0

*Dimensions in mm

Heat Shrink T Type Boot

Gala T-Type Heat Shrink Boot offers mechanical protection and stress relief at cable bifurcations. Designed for durability, it ensures a secure fit and long-term reliability in demanding applications.



Selection Chart :

Part No.	W (mm)	H (mm)	L (mm)	P (mm)	W (mm)	H (mm)	L (mm)	P (mm)
0001-001	10.0	1.0	11.0	1.0	10.0	1.0	11.0	1.0
0001-002	11.0	1.0	12.0	1.0	11.0	1.0	12.0	1.0
0001-003	12.0	1.0	13.0	1.0	12.0	1.0	13.0	1.0
0001-004	13.0	1.0	14.0	1.0	13.0	1.0	14.0	1.0

*Dimensions in mm

Heat Shrink Q Type Boot

Gala Heat Shrink Q Type Boot offers mechanical protection and stress relief of wiring harness information. Designed for durability, it ensures a secure fit and long term reliability in various applications.



Selection Chart :

Code	Ø	Ø	Ø	Ø	Ø	Ø	Ø	Ø	Ø	Ø	Ø	Ø	Ø
1000-001	10	12	15	18	22	28	35	45	55	70	90	110	140
1000-002	14	18	22	28	35	45	55	70	90	110	140	180	230

* Ø Dimension in mm

Heat Shrink Q Type Boot (30° Bifurcated)

Gala 30° Q Type Heat Shrink Boot provides mechanical protection and stress relief at cable information. Designed for durability, it ensures a secure fit and long term reliability in demanding applications.

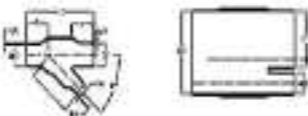

Selection Chart :

Code	Ø	Ø	Ø	Ø	Ø	Ø	Ø	Ø	Ø	Ø	Ø	Ø
1000-001	10	12	15	18	22	28	35	45	55	70	90	110
1000-002	14	18	22	28	35	45	55	70	90	110	140	180

* Ø Dimension in mm

Heat Shrink Y Type Boot

Gala The Late Y-Type Heat Shrink Boot offers mechanical protection and stress relief of cable information. Designed for durability, it ensures a secure fit and long term reliability in demanding applications.



Selection Chart :

Code	Ø	Ø	Ø	Ø	Ø	Ø	Ø
1000-001 1000-002, 1000-003, 1000-004	10-20	12-20	15-20	18-20	22-20	28-20	35-20
1000-005	15-20	18-20	22-20	28-20	35-20	45-20	55-20
1000-006	20-20	25-20	30-20	35-20	40-20	45-20	50-20
1000-007	25-20	30-20	35-20	40-20	45-20	50-20	55-20

* Ø Dimension in mm

Heat Shrink 2 Way Boot

Dura Heat Shrink Boot provides protection and stress relief at cable bifurcations. Designed for durability, it ensures a secure fit and long-term reliability in demanding applications.



Selection Chart:

Part No.	Ø (mm)	Ø (inch)	Ø (mm)	Ø (inch)	Ø (mm)	Ø (inch)	Ø (mm)	Ø (inch)	Ø (mm)	Ø (inch)
200-200	12.5	1/2	1.5	1/8	1.5	1/8	1.5	1/8	1.5	1/8
200-201	12.5	1/2	1.5	1/8	1.5	1/8	1.5	1/8	1.5	1/8
200-202	12.5	1/2	1.5	1/8	1.5	1/8	1.5	1/8	1.5	1/8
200-203	12.5	1/2	1.5	1/8	1.5	1/8	1.5	1/8	1.5	1/8

*Ø Dimensions in inches

Heat Shrink E Type Boot

Dura Heat Shrink Boot offers mechanical protection and stress relief for three wire bifurcations. Designed for durability, it ensures a secure fit and long-term reliability in demanding applications.



Selection Chart:

Part No.	Ø (mm)	Ø (inch)	Ø (mm)	Ø (inch)	Ø (mm)	Ø (inch)	Ø (mm)	Ø (inch)	Ø (mm)	Ø (inch)
200-200	12.5	1/2	1.5	1/8	1.5	1/8	1.5	1/8	1.5	1/8
200-201	12.5	1/2	1.5	1/8	1.5	1/8	1.5	1/8	1.5	1/8
200-202	12.5	1/2	1.5	1/8	1.5	1/8	1.5	1/8	1.5	1/8
200-203	12.5	1/2	1.5	1/8	1.5	1/8	1.5	1/8	1.5	1/8

*Ø Dimensions in inches

Heat Shrink 3 Way Boot

Dura Heat Shrink Boot provides mechanical protection and stress relief for three-way cable bifurcations. Designed for durability, it ensures a secure fit and long-term reliability in demanding applications.

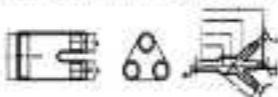

Selection Chart:

Part No.	Ø (mm)	Ø (inch)	Ø (mm)	Ø (inch)	Ø (mm)	Ø (inch)	Ø (mm)	Ø (inch)	Ø (mm)	Ø (inch)
200-200	12.5	1/2	1.5	1/8	1.5	1/8	1.5	1/8	1.5	1/8
200-201	12.5	1/2	1.5	1/8	1.5	1/8	1.5	1/8	1.5	1/8
200-202	12.5	1/2	1.5	1/8	1.5	1/8	1.5	1/8	1.5	1/8
200-203	12.5	1/2	1.5	1/8	1.5	1/8	1.5	1/8	1.5	1/8
200-204	12.5	1/2	1.5	1/8	1.5	1/8	1.5	1/8	1.5	1/8

*Ø Dimensions in inches

Heat Shrink 4 Way Toot

Gala Heat Shrink Toot provides mechanical protection and stress relief for four way wire interconnections. Designed for stability, it prevents a loose fit and long term reliability in demanding applications.

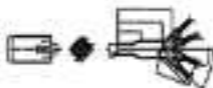

Selection Chart:

Series	W. Size	H. Size	Min. Wire Size	Max. Wire Size	Max. No. of Wires	W. Length	H. Length	W. Dia.	H. Dia.	W. Dia.	H. Dia.	W. Dia.	H. Dia.	W. Dia.	H. Dia.
HTS-100	1.00	1.25	1.00	1.25	4	1.00	1.25	0.10	0.125	0.10	0.125	0.10	0.125	0.10	0.125
HTS-150	1.50	1.75	1.50	1.75	4	1.50	1.75	0.15	0.1875	0.15	0.1875	0.15	0.1875	0.15	0.1875
HTS-200	2.00	2.25	2.00	2.25	4	2.00	2.25	0.20	0.25	0.20	0.25	0.20	0.25	0.20	0.25
HTS-250	2.50	2.75	2.50	2.75	4	2.50	2.75	0.25	0.3125	0.25	0.3125	0.25	0.3125	0.25	0.3125
HTS-300	3.00	3.25	3.00	3.25	4	3.00	3.25	0.30	0.375	0.30	0.375	0.30	0.375	0.30	0.375
HTS-350	3.50	3.75	3.50	3.75	4	3.50	3.75	0.35	0.4375	0.35	0.4375	0.35	0.4375	0.35	0.4375
HTS-400	4.00	4.25	4.00	4.25	4	4.00	4.25	0.40	0.50	0.40	0.50	0.40	0.50	0.40	0.50
HTS-450	4.50	4.75	4.50	4.75	4	4.50	4.75	0.45	0.5625	0.45	0.5625	0.45	0.5625	0.45	0.5625
HTS-500	5.00	5.25	5.00	5.25	4	5.00	5.25	0.50	0.625	0.50	0.625	0.50	0.625	0.50	0.625
HTS-550	5.50	5.75	5.50	5.75	4	5.50	5.75	0.55	0.6875	0.55	0.6875	0.55	0.6875	0.55	0.6875
HTS-600	6.00	6.25	6.00	6.25	4	6.00	6.25	0.60	0.75	0.60	0.75	0.60	0.75	0.60	0.75
HTS-650	6.50	6.75	6.50	6.75	4	6.50	6.75	0.65	0.8125	0.65	0.8125	0.65	0.8125	0.65	0.8125
HTS-700	7.00	7.25	7.00	7.25	4	7.00	7.25	0.70	0.875	0.70	0.875	0.70	0.875	0.70	0.875
HTS-750	7.50	7.75	7.50	7.75	4	7.50	7.75	0.75	0.9375	0.75	0.9375	0.75	0.9375	0.75	0.9375
HTS-800	8.00	8.25	8.00	8.25	4	8.00	8.25	0.80	1.00	0.80	1.00	0.80	1.00	0.80	1.00
HTS-850	8.50	8.75	8.50	8.75	4	8.50	8.75	0.85	1.0625	0.85	1.0625	0.85	1.0625	0.85	1.0625
HTS-900	9.00	9.25	9.00	9.25	4	9.00	9.25	0.90	1.125	0.90	1.125	0.90	1.125	0.90	1.125
HTS-950	9.50	9.75	9.50	9.75	4	9.50	9.75	0.95	1.1875	0.95	1.1875	0.95	1.1875	0.95	1.1875
HTS-1000	10.00	10.25	10.00	10.25	4	10.00	10.25	1.00	1.25	1.00	1.25	1.00	1.25	1.00	1.25

For dimensions in mm